

Fig. 16 MIDDLE DRIVE GEAR

Ref. No.	Part No.	Part Name	Remarks
1	1J7-17537-Y0-15	SHIM, THRUST	1 UR
	1J7-17537-Y0-30	SHIM, THRUST	1 UR
	1J7-17537-Y0-40	SHIM, THRUST	1 UR
	1J7-17537-Y0-50	SHIM, THRUST	1 UR
	1J7-17537-Y0-60	SHIM, THRUST	1 UR
2	93306-20636	BEARING	1
3	11H-15383-01	PLATE, BEARING COVER	2
4	90149-08152	SCREW	4
5	1YW-17522-00	PINION, DRIVE	1
6	90179-22526	NUT	1
7	93306-20461	BEARING	1
8	2HR-17553-00	SHAFT, MIDDLE DRIVEN	1
9	1YW-17552-00	PINION, DRIVEN	1
10	2HR-W1752-00	HOUSHING COMP.	1
11	90387-257R2	COLLAR	1
12	93210-63514	O-RING	1
13	1YW-17527-00	CAM, DRIVEN	1 UR
	1YW-17527-10	CAM, DRIVEN	1 UR
14	90501-602E2	SPRING, COMPRESSION	1
15	90201-206K8	WASHER, PLATE	1
16	3H5-17529-00	WASHER, THRUST	2
17	59V-17531-00	SHIM, PINION	2 UN
	59V-17531-10	SHIM, PINION	2 UN
	59V-17531-20	SHIM, PINION	2 UN
	59V-17531-30	SHIM, PINION	2 UN
	59V-17531-40	SHIM, PINION	2 UN
	59V-17531-50	SHIM, PINION	2 UN
	59V-17531-60	SHIM, PINION	2 UN

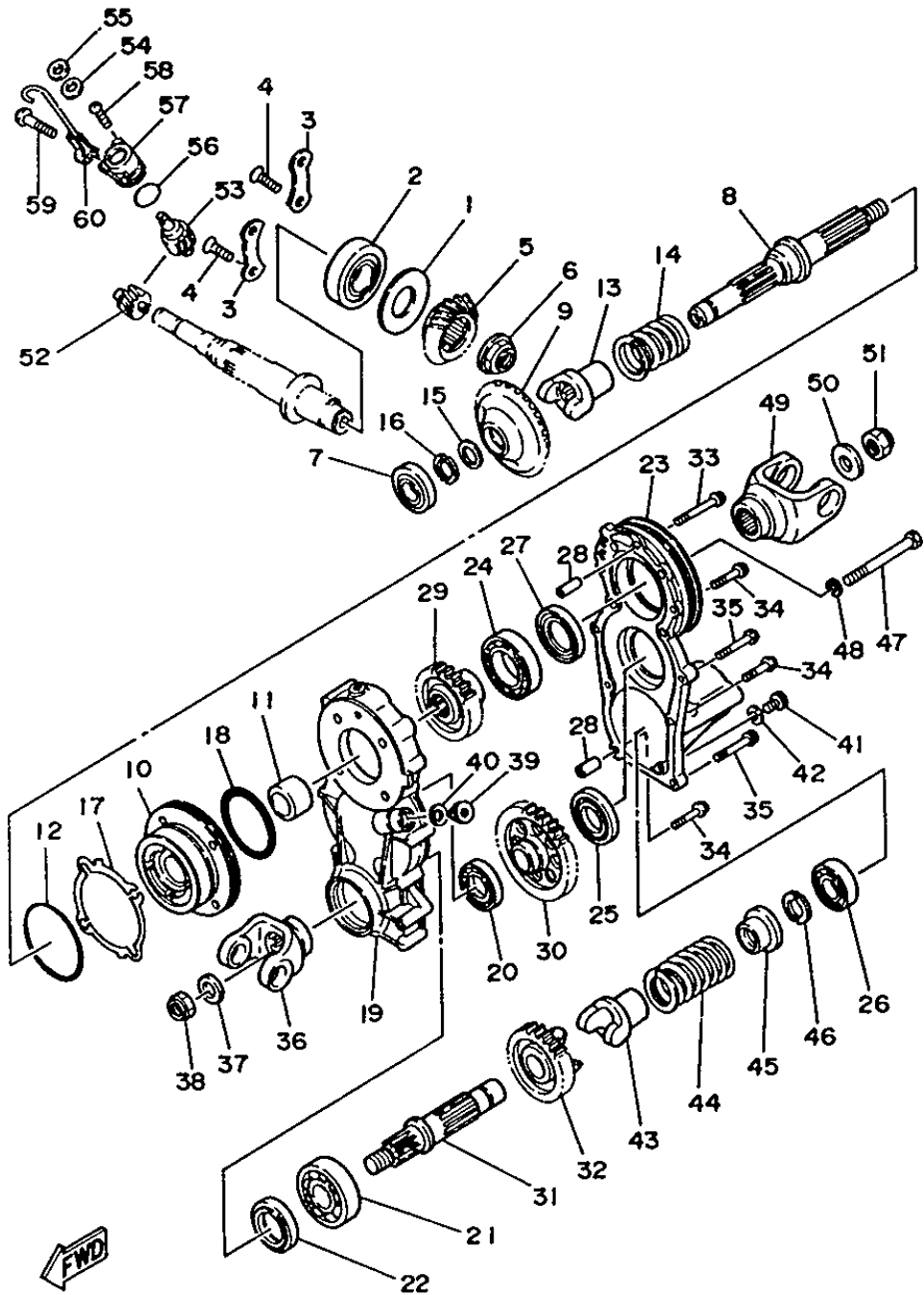

Fig. 16 MIDDLE DRIVE GEAR

Ref. No.	Part No.	Part Name	Quantity	Remarks
18	93210-59748	O-RING	1	
19	2HR-17541-00	CASE, TRANSFER 1	1	
20	93316-00604	BEARING	1	
21	93306-30551	BEARING	1	
22	93105-35027	OIL SEAL	1	
<hr/>				
23	2HR-17542-01	CASE, TRANSFER 2	1	
24	93306-00702	BEARING	1	
25	93316-00604	BEARING	1	
26	93306-00435	BEARING	1	
27	93101-35097	OIL SEAL	1	
<hr/>				
28	99510-08016	PIN, DOWEL	2	
29	2HR-17586-00	GEAR, TRANSFER DRIVE	1	
30	22U-17587-00	GEAR, IDLER	1	
31	22U-17553-01	SHAFT, MIDDLE DRIVEN	1	
32	2HR-17588-01	GEAR, TRANSFER DRIVEN	1	
<hr/>				
33	95021-06050	BOLT, FLANGE	1	
34	95023-06040	BOLT, FLANGE	5	
35	95023-06030	BOLT, FLANGE	3	
36	2HR-17576-00	YOKE,JOINT 2	1	
37	90201-14633	WASHER, PLATE	1	
<hr/>				
38	90185-14070	NUT, SELF-LOCKING	1	
39	90340-14029	PLUG, STRAIGHT SCREW	1	
40	214-11198-01	GASKET	1	
41	95023-08012	BOLT, FLANGE	1	
42	90201-08087	WASHER, PLATE	1	
<hr/>				
43	22U-17527-00	CAM, DRIVEN	1	
44	90501-605E1	SPRING, COMPRESSION	1	
45	22U-17524-00	HOLDER	1	

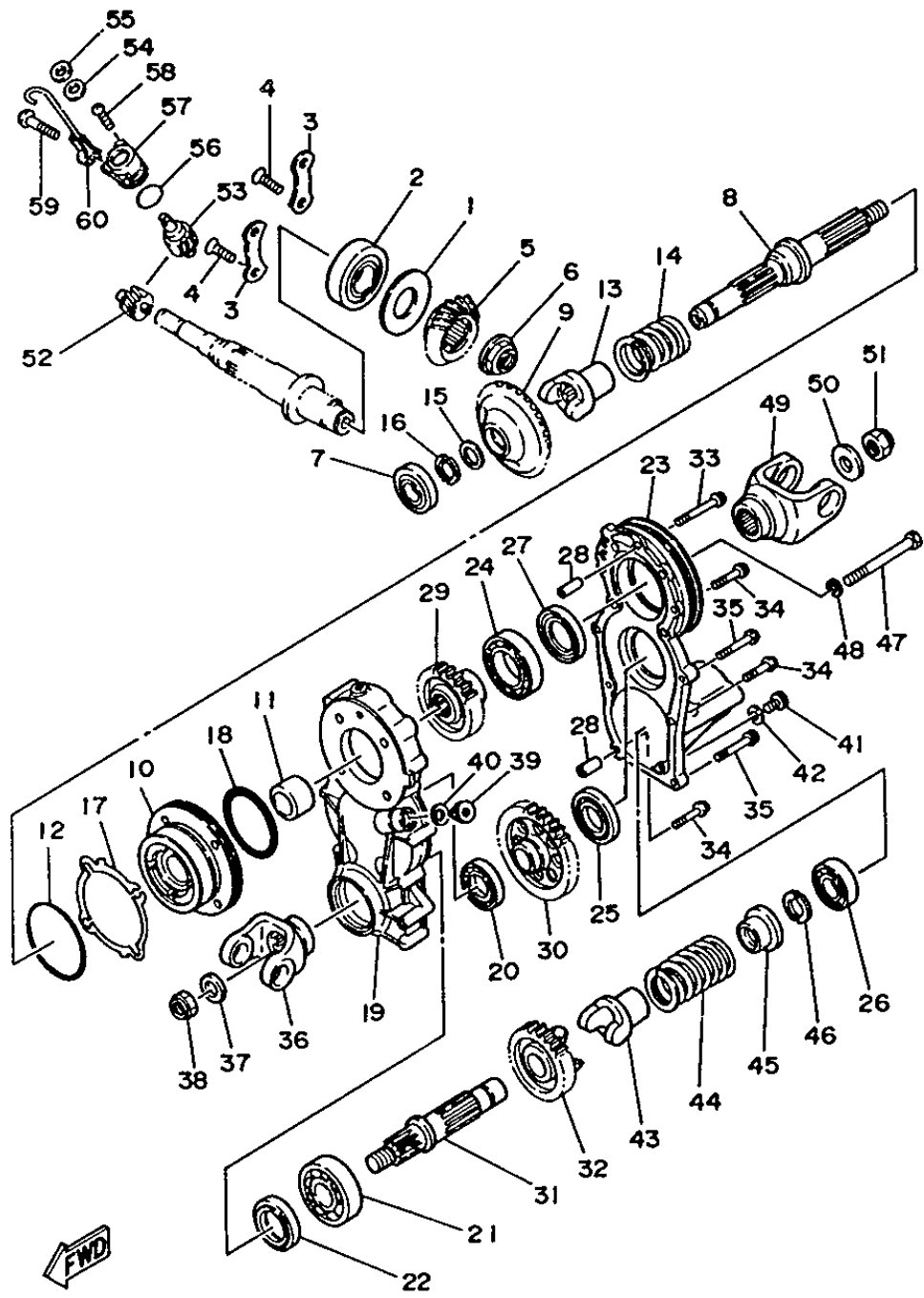

Fig. 16 MIDDLE DRIVE GEAR

Ref. No.	Part No.	Part Name	Remarks
46	3H5-17529-00	WASHER, THRUST	2
47	97021-08085	BOLT	4
48	92901-08600	WASHER, PLATE	4
49	2HR-17556-00	YOKE, JOINT	1
50	90201-14633	WASHER, PLATE	1
51	90185-14070	NUT, SELF-LOCKING	1
52	59V-17831-00	GEAR, DRIVE	1
53	59V-17841-00	GEAR, DRIVEN	1
54	90201-12M34	WASHER, PLATE	1
55	93102-08307	OIL SEAL	1
56	93210-24253	O-RING	1
57	59V-17811-00	HOUSING, TACHOMETER GEAR	1
58	98506-06016	SCREW, PAN HEAD	1
59	98516-06030	SCREW, PAN HEAD	1
60	2HR-83599-00	GUIDE, WIRE	1